

VASANTRAO KALE HOMOEOPATHIC MEDICAL COLLEGE & HOSPITAL

P-12, M.I.D.C., BARSHI ROAD,
LATUR. – 413 531 (MAHARASHTRA)
Ph.: (02382) 221389, Fax : (02382) 222523
e-mail: kspmsshmclatur@gmail.com
vkhmclatur@gmail.com
Website: www.vkhmclatur.com

Ref. : VKHMC/ / 2021 - 2022

Date : / / 2022.

Infrastructure requirements of a Homoeopathic College

(For intake Capacity from 61 to 100 Students)

Sr. No.	Particulars	Built up area (in sq.mt.)		
		Required	Existing	Deficient
1	Administrative section :- This shall includes Principal Room, Reception, Visitors Room, Committee Room, Administration and Account Section, Record Room, Separate Toilet for male and female.	150	91.82	--
2	Lecture Halls:- there shall be 5 Lecture Halls with capacity to accommodate 100 students with proper facilities for Electricity, Audio – Visual Aids, Fans/Coolers with separate toilet for Boys and Girls on Each Floor.	500	397.18	--
3	Seminar / Examination Hall	150	204.32	--
4	Central Library with sitting capacity of atleast 50-60 students with reading room for teachers, separate reading room for P.G students, Librarian Room, Library shall have atleast 2000 Books on prescribed subjects. The Library shall have newspaper periodical, journal (specifically for the subject to be taught).	120	204.38	--
5	Teaching Department -			
	(a) Anatomy with a well ventilated dissection hall with wash basin, storage for cadaver and museum with facility of histology demonstration.	90	127.74	--
	(b) Physiology with separate laboratories for physiology and Biochemistry, Museum and Demonstration room.	90	85.94	--
	(c) *Homoeopathic Pharmacy Laboratory with Museum cum Demonstration room.	90	62.71	--
	(d) Pathology Laboratory with Museum cum Demonstration room.	90	62.71	--
	(e) Forensic Medicine & Toxicology Museum cum Demonstration room.	60	43.66	--
	(f) Community Medicine Museum cum Demonstration room.	60	43.66	--
	(g)* Practice of Medicine Museum Cum Demonstration room.	60	123.10	--
	(h) Gynecology& Obstetrics Museum Cum Demonstration room.	60	43.66	--
	(i) Surgery Museum Cum Demonstration room	60	52.33	--

	(j) *Homoeopathic MateriaMedica Museum Cum Demonstration room.	60	45.89	--
	(k) *Organon of Medicine including History of Medicine Museum cum Demonstration room.	60	45.89	--
	(l) *Repertory with computer lab & Demonstration room.	60	45.89	--
6	Common Rooms for Boys and Girls with adequate sitting arrangement and locker	40	32.52	--
7	Canteen Facility in the college premises.	75	81.05	--
	Total	1875	1794.45	

(Note : The said space requirement shall not be applicable for the colleges established prior to notification of HCC, Regulation – 2013. However, it is mandatory to mention the actual available infrastructure).

Principal
Vasant Rao Kale Homoeopathic
 Medical College & Hospital M.I.D.C.
 Latur

(24)
III

MIDC



MAHARASHTRA INDUSTRIAL DEVELOPMENT CORPORATION
(A Government of Maharashtra Undertaking)

Phone: 632 54 51-3
Grams: AREADEV
Telex: 0111-3789

Regional Office,
Opp. Subhan Talkies,
Near Roly Station Road,
Aurangabad

Marol Industrial Area,
Mahakali Caves Road,
Andheri (East),
BOMBAY-400093.

By Regd. Post A. D.

No. **LTR/MCA/488/P-12/395**

Date: **2/2/1988**

Subject: **Latur** Industrial Area—
Allotment of land at—

Read: Application dated the **29th** day of **Janu.** 1988 received
from Shri/Smt/Messrs. **Kisan Shikshan Prasangh Mandal.**

ORDER

Sanction is hereby accorded to the allotment of land admeasuring
2,000 square metres comprising of plot (s) No. (s) **P-12,**
from **Latur** Industrial Area to—

- (i) Shri/Smt./Kumari _____
trading as Proprietor under the name of M/s. _____ having his/her
office at _____
- (ii) Sarvashri _____
carrying on business in partnership under the firm name & style of
M/s. _____
having their office at _____
- (iii) M/s. **Kisan Shikshan Prasangh Mandal**
a Company incorporated under the Companies Act, 1956 having its registered
office at _____

subject to the payment of the premium of Rs. **20,000/-** calculated at the rate
Rs. **10/-** per square metre and subject to the following conditions:—

- (1) The allotment is valid to set up an unit for manufacture of **school building** and for
other products specifically permitted from time to time.
~~This shall be subject to the restrictions applicable or imposed by the Directorate of
Industries State or Central Govt. in this behalf.~~
- (2) The amount of earnest money received with the application will be appropriated
towards the amount of premium. The allottee shall pay the sum of Rs. **20,000/-**
(Rupees **Twenty thousand** only) being the balance amount of the
premium within a period of 30 days from the date of receipt of this order.
- (3) ~~In case the allottee fails to pay the balance amount of premium within the period mentioned
above, the allotment shall be liable to be cancelled without further notice.~~
- (4) ~~In the event of the allotment being cancelled as aforesaid, the Corporation will be entitled
to forfeit the whole of the earnest money received with application.~~
- (5) The terms and conditions of allotment of land will be those as contained in the standard
form of Agreement to Lease and the Lease annexed thereto and are in substance as follows:—

Principal
Vasantrao Kale Homoeopathic Medical College & Hospital M.I.D.C.
Latur

Principal
Vasantrao Kale Homoeopathic Medical College & Hospital M.I.D.C.
Latur

35 (29)

Latur Industrial Area.

Village! - Varavanti Tg. Dist. Latur

Scale 1:2000

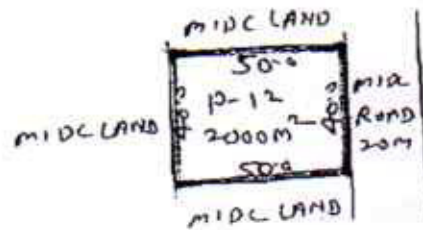

Corried by
R.S. Gote

(R. S. Gote)

वसंतराव
सेकरणी
किसान शि. झ. मंडळ
बोवगाव (कांदेचे).
ता. जि. लातूर.



५

(G. M. PARMAR.)

Regional Officer.

Maharashtra Industrial Development Corporation,

Principal

Vasant Rao Kale Homoeopathic
Medical College, M.I.D.C., Latur

Vasant Rao Kale Homoeopathic
Medical College, M.I.D.C., Latur

Vasant Rao Kale Homoeopathic
Medical College & Hospital M.I.D.C.
Latur

Principal

Vasant Rao Kale Homoeopathic
Medical College & Hospital M.I.D.C.
Latur

III

26

MIDC



Marol Indl. Area,
Mahakali Caves Marg,
Marol, Andheri (E),
Bombay-400 093.

By R. P. A. D.
No MIDC/

Date: 14/8/96

31/11/96 1657

Sub :- Industrial Area

Allotment of land at ..

Latur

Ref :- Application dated the _____ days of _____ received from

12 the

Shri/Smt/Messrs _____

////// **Rishabh Chitambar**

Pranavh Bhandal

: O R D E R :

Sanction is hereby accorded to the allotment of land admeasuring _____ sq. Mtrs. comprising of Plot No. _____ From _____ Industrial Area to :

i) Shri/Smt./Kumari **3-70** **1-70** **1-61** **Latur** trading as proprietor under the name of M/s. _____

having his/her office at _____

ii) Sarvashri _____

carrying on business in partnership under the firm name and style of M/s _____

having their office at _____

iii) M/s. _____ a Company incorporated under the Companies Act, 1956 having its registered office at **Shri Rishabh Chitambar Pranavh Bhandal**

Shri Rishabh Chitambar Pranavh Bhandal incorporated under the society's registration no. 1000 having its registered office at Surpan (Hill) Te. & Dist. Latur.

Subject to the payment of the premium of Rs. _____ calculated at the rate of Rs. _____ per sq. Mtrs and subject to the following conditions :-

20/-

Principal

Vasant Rao Kale Homoeopathic Medical College & Hospital M.I.D.C.

Principal **Latur**

Vasant Rao Kale Homoeopathic Medical College & Hospital M.I.D.C. Latur

the said land or any part thereof for any other purpose nor for the purpose of any factory which may be abnoxious, offensive by reason of emission of odour, liquid effluvia, dust, smoke, gas nuisance, vibration or fire hazards.

f) The other terms and conditions of allotment shall be those contained in the prescribed forms of Agreement to Lease and the Lease.

g) The stamp duty in respect of the preparation and execution of the Agreement to Lease and its duplication as also the lease and its duplication in respect of the allotted plot of land as also the legal costs for the preparation and execution of these documents including the registration fees shall be borne and paid by the allottee alone.

The allottee may submit his application for telephone connection to the concern telephone authority immediately, after taking over possession of the plot. This will enable the telephone authorities to build up a waiting list and ensure proper planning to provide telephone connections. **As the plots have been provided with wire fencing by MIDC, you will have to pay fencing charges which will be communicated to you alongwith balance premium. Thereafter agreement to lease will be executed.**

To,

The Secretary,

Risen Chikhan Prasarak Mandal

Soergam (Kaleche)

To, & Dist. Latur

Area Manager,
Regional Officer, M.I.D.C.
(S. S. Sankar)
Regional Officer
MIDC, Latur.

01/08/96
14/8/96

Copy f. w. cc to :

alongwith copy of measurement plan.
The plot nos. have been designated as per discussion on phone with
Asstt. Planner, MIDC, Latur, y-400 093.

— Latur

2) The Area Manager MIDC., Division No. _____

Latur

3) The Area Manager Desk VII MIDC., Bombay / Land Survey Office, Latur
Regional Officer MIDC., _____ Region _____ with request to
supply five copies of plan immediately to Area Manager (Desk-).

Deputy Chief Accounts Officer, MIDC. SPSD Dr.
Surayabadi.

5) The Area Manager Desk No. _____, Sub-Division Latur. He is requested to
communicate the fencing charges of the fencing provided to the
above plots immediately.

Principal
Vasant Rao Kale Homoeopathic
Medical College & Hospital M.I.D.C.,
Latur

Principal
Vasant Rao Kale Homoeopathic
Medical College, M.I.D.C., Latur

INDUSTRIAL AREA.
 Village Waranan Tq. Latur Dist. Latur
 SCALE: 1 C. M. = 200 MTS.

875
 28

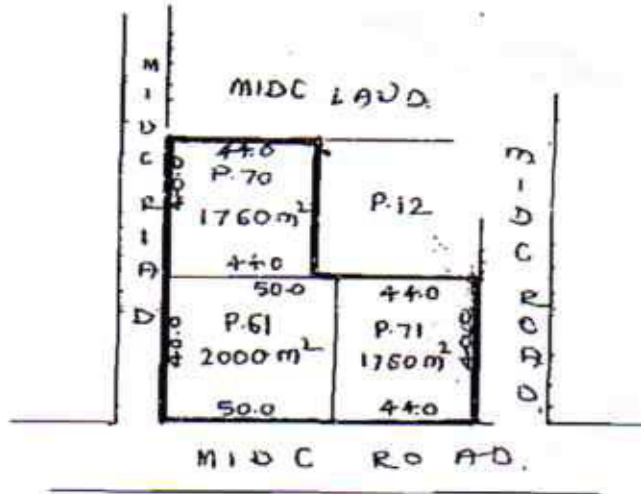

Copied by

Campbell

V. D. Trimukhey
 Surveyor

R.O. M.I.D.C.
 LATUR 413531



दलिकर
 सचिव
 किसान शिक्षण तालिम मंडळ
 बोरगाव, कोल्हापूर जिल्हा, अहमदनगर

S. S. Sawant
 Regional Officer
 M. I. D. C. LATUR

Principal
 Vasant Rao Kale Homoeopathic
 Medical College, M.I.D.C., Latur

Principal
 Vasant Rao Kale Homoeopathic
 Medical College & Hospital M.I.D.C.
 Latur

Principal
 Vasant Rao Kale Homoeopathic
 Medical College, M.I.D.C., Latur

Principal
 Vasant Rao Kale Homoeopathic
 Medical College & Hospital M.I.D.C.
 Latur

Maharashtra Industrial Development Corporation

(A Government Of Maharashtra Undertaking)

Tel : +91-2382-220220

Fax : +91-2382-220934

E-mail : rofatur@midcindia.org

Regional Office, Latur
C.F.C. Building,
MIDC Industrial Area,LATUR
413512

29

No. RLT/LTR/Case No.763/4587

Date : 22-Nov-2005

Sub : LATUR INDUSTRIAL AREA
Allotment of land at...Ref : Application dated 07-Nov-2005 received from
SECRETARY, M/S. KISAN SHIKSHAN PRASARAK MANDAL**: ORDER :**

Sanction is hereby accorded to the allotment of land admeasuring 2520 Square Meters comprising of Plot No. P-79 in LATUR INDUSTRIAL AREA to Secretary, M/S. KISAN SHIKSHAN PRASARAK MANDAL BORGADON (KALE) TQ.DIST. LATUR for setting up of your Educational Purpose of HOSPITAL & HOSTEL.

Subject to the payment of the premium of Rs.567,000/- calculated at the rate of Rs.225.00/- per Square Meter and subject to the following conditions.

1. The amount of earnest money received with the application will be appropriated towards the amount of premium. The allottee shall pay the sum of Rs.283,500/- (Rs. Two lakh eighty three thousand five hundred only) being the balance amount of the premium within a period of 30 days from the date of receipt of this order, by DD, drawn in favor of MIDC, Latur Payable on any branch at Latur
2. In case the allottee fails to pay the balance amount of premium within the period mentioned above, the allotment shall be liable to be cancelled without further notice.
3. In the event of the allotment being cancelled as foresaid the corporation will be entitled to forfeit the whole of the earnest money received with the application.
4. The terms & conditions of allotment of land will be those contained in the standard form of agreement to lease and the lease annexed thereto & in substance are as follows.
 - a) The allottee shall enter into an agreement to lease in the form prescribed by Corporation & on performance of the conditions will be entitled to lease for term of ninety five (95) years to be computed from the date of execution of the agreement to lease and renewable for one further term 95 years on payment of premium and on such terms and conditions as may be determined by the Corporation at the time of renewal.
 - b) The annual ground rate rent of Rupees 1/- per annum is payable in respect of the plot of land allotted.
 - c) The allottee shall get the plan and specification of the proposed factory building duly approved from the Executive Engineer of the said Industrial area and complete the said building in accordance with approved plans and shall obtain a completion certificate from the Executive Engineer of the said industrial area

Principal

Vasantrao Kale Homoeopathic
Medical College & Hospital M.I.D.C.
Latur

Page 1 of 2

Principal

Vasantrao Kale Homoeopathic
Medical College & Hospital M.I.D.C.
Latur

1/2

- d) The allottee shall not directly or indirectly transfer or assign the benefits of interest in the agreement lease or part with possession of the land or any part thereof without previous consent of the corporation who may refuse or grant it subject to such condition as the corporation may think fit including a condition for payment of additional premium.
- e) The allottee shall be entitled to use land for the purpose of a factory but not for the purpose of a factory for any of the obnoxious industries specified in the annexure set out in the schedule to the agreement to lease and shall not use the said land or any part thereof for an other purpose not for the purpose of any factory which may be obnoxious, offensive by reason of emission of odor, liquid effluvia, dust, smoke, gas, nuisance, vibration or fire hazards.
- f) The other terms and conditions of allotment shall be those contained in the prescribed form of agreement to lease & the lease.
- g) The stamp duty in respect of preparation & execution of the agreement to lease & its duplication as also the lease & its duplication in respect of the allotted plot of land as also the legal costs for the preparation and execution of these documents including the registration fees shall be borne and paid by the allottee alone within a prescribed period.
- h) The Allotment Order is issued subject to Consent From MPCB and Permission from FDA Department.
- i) Plot No. P-79 admeasuring 2520 sqm. has fenced from barbid wire the cost of the same should be paid by you and the same will be communicated separately.

The allottee may submit his application for telephone connection to the concern telephone authority immediately, after taking over the possession of the plot. This will enable the telephone authorities to build up a waiting list & ensure proper planning to provide timely telephone connection to the industrial units in the area.

Please also note A to L will be signed with you within 30 days from the date of receipt of Balance Occupancy Premium Amount.

Regional Officer,
MIDC, LATUR

To,

Secretary

M/S. KISAN SHIKSHAN PRASARAK MANDAL, BORGAON (KALE)
C/O. PLOT NO. P-12
MIDC INDL AREA
LATUR

Copy submitted to :

- 1) The Dy. Chief Account Officer, MIDC, Aurangabad.
- 2) The Chief Planner, MIDC, Mumbai - 400 093.
- 3) The Technical Advisor, MIDC, Mumbai - 400 093.
- 4) Executive Engineer MIDC Division, Latur

Copy f.w.c.s to :

1. Dy. Engineer, SPA, Latur.

Copy to :

1. Head Surveyor / Surveyor Regional Office MIDC, LATUR

Regional Officer,
MIDC, LATUR

Principal

Vasant Rao Kale Homoeopathic
Medical College & Hospital M.I.D.C.

Latur

Principal

Vasant Rao Kale Homoeopathic
Medical College, M.I.D.C., Latur

Principal

Vasant Rao Kale Homoeopathic
Medical College & Hospital M.I.D.C.

Latur

Principal

Vasant Rao Kale Homoeopathic
Medical College, M.I.D.C., Latur

(31)

Latur INDUSTRIAL AREA
Village Waryantra Dist. Latur
Plot No. P-79 Area 2520 m²

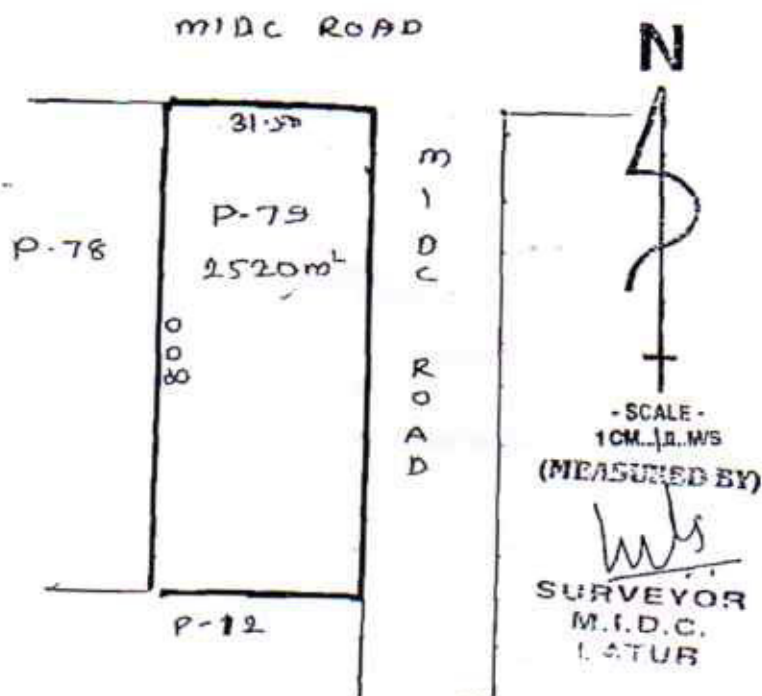

Ganesh
सचिव
किसान शिक्षण मंडळ
बोरोगाव (ता. ल. लतूर)

Principal
Vasant Rao Kale Homoeopathic
Medical College & Hospital M.I.D.C.
Latur

Principal
Vasant Rao Kale Homoeopathic
Medical College & Hospital M.I.D.C.
Latur